

Rod Buffer Seals

Technical details

Metric

Inch

Operating conditions

Maximum Speed	4.0 m/sec
Temperature Range	-30°C +100°C
Maximum Pressure	300 bar

12.0 ft/sec
-22°F +212°F
4500 p.s.i.



Maximum extrusion gap

Figures show the maximum permissible gap all on one side using minimum rod \varnothing and maximum clearance \varnothing .

Pressure bar	100	150	250	300
Maximum Gap mm	0.6	0.5	0.45	0.4
Pressure p.s.i.	1500	2400	3750	4500

Surface roughness

	μmRa	μmRt	μinCLA	μinRMS
Dynamic Sealing Face $\varnothing d_1$	0.1 <-> 0.4	4 max	4 <-> 16	5 <-> 18
Static Sealing Face $\varnothing D_1$	1.6 max	10 max	63 max	70 max
Static Housing Faces L_1	3.2 max	16 max	125 max	140 max

Chamfers & Radii

Min Chamfer C mm	5.00
Max Fillet Rad r_1 mm	0.80

Tolerances

	$\varnothing d_1$	$\varnothing D_1$	L_1 mm
mm	f9	H10	+0.2 -0

SRS

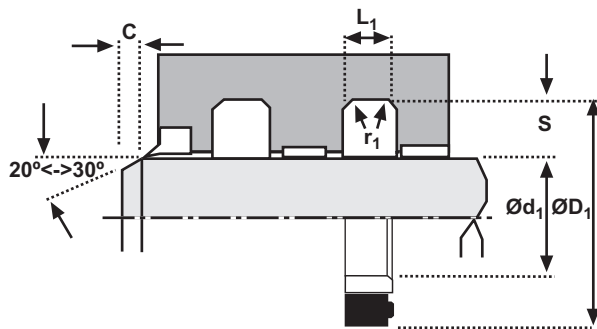

Design

CDI's Secondary Rod Seal (SRS) is a two-piece single acting seal, with a filled PTFE cap ring and an elastomeric energizer. It is designed to protect the primary rod seal from pressure spikes.

Features

- Low friction - no stick slip
- Self relieving design prevents pressure trapping
- High strength machined PTFE cap ring
- Wide range of materials, available for special applications
- Extended temperature ranges

ORDERING INFORMATION

Example: Rod Diameter 80mm

Product code	SRS	SRS-80MM - N	702
Rod Diameter			
Energizer Material	N = NBR, H = HNBR F = FKM, E = EPDM		
SRS Ring Material	702 PTFE 15% Glass, 5% MoS2 741 PTFE 40% Bronze		

SRS

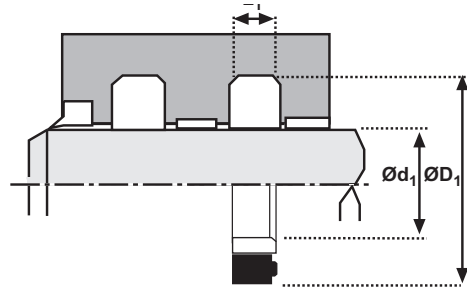

Ød ₁	TOL f9	ØD ₁	TOL H10	L ₁ +0,2	PART NUMBER
40	-0,025	55,6	+0,100	6,3	SRS-40MM
	-0,087		+0,000		
45	-0,025	60,6	+0,100	6,3	SRS-45MM
	-0,087		+0,000		
50	-0,025	65,6	+0,100	6,3	SRS-50MM
	-0,087		+0,000		
55	-0,030	70,6	+0,120	6,3	SRS-55MM
	-0,104		+0,000		
60	-0,030	75,6	+0,120	6,3	SRS-60MM
	-0,104		+0,000		
65	-0,030	80,6	+0,120	6,3	SRS-65MM
	-0,104		+0,000		
70	-0,030	85,6	+0,120	6,3	SRS-70MM
	-0,104		+0,000		
75	-0,030	90,6	+0,120	6,3	SRS-75MM
	-0,104		+0,000		
80	-0,030	95,6	+0,120	6,3	SRS-80MM
	-0,104		+0,000		
85	-0,036	100,6	+0,140	6,3	SRS-85MM
	-0,123		+0,000		
90	-0,036	105,6	+0,140	6,3	SRS-90MM
	-0,123		+0,000		
95	-0,036	110,6	+0,140	6,3	SRS-95MM
	-0,123		+0,000		
100	-0,036	115,6	+0,140	6,3	SRS-100MM

Ød ₁	TOL f9	ØD ₁	TOL H10	L ₁ +0,2	PART NUMBER
			+0,000		
105	-0,036	120,6	+0,140	6,3	SRS-105MM
	-0,123		+0,000		
110	-0,036	125,6	+0,140	6,3	SRS-110MM
	-0,123		+0,000		
115	-0,036	130,6	+0,140	6,3	SRS-115MM
	-0,123		+0,000		
120	-0,036	135,6	+0,140	6,3	SRS-120MM
	-0,123		+0,000		
125	-0,043	140,6	+0,160	6,3	SRS-125MM
	-0,143		+0,000		
130	-0,043	145,6	+0,160	6,3	SRS-130MM
	-0,143		+0,000		
135	-0,043	150,6	+0,160	6,3	SRS-135MM
	-0,143		+0,000		
140	-0,043	155,6	+0,160	6,3	SRS-140MM
	-0,143		+0,000		
150	-0,043	165,6	+0,160	6,3	SRS-150MM
	-0,143		+0,000		
160	-0,043	175,6	+0,160	6,3	SRS-160MM
	-0,143		+0,000		
170	-0,043	185,6	+0,160	6,3	SRS-170MM
	-0,143		+0,000		
180	-0,043	195,6	+0,160	6,3	SRS-180MM
	-0,143		+0,000		